

Auger Cast Piles

Auger Cast Pile (ACP) provide steel-reinforced, pressure-grouted, structural deep foundations using partial- and full-displacement methods for reliable, high-capacity support of heavy foundation loads. Traditional ACP uses a continuous flight auger to drill through dense soil layers and to reach design depths. ACP strength and reliability are also enhanced by the pressure grout effect during construction. ACP construction produces low noise and no vibrations and is used in the same way as a driven pile; to support heavy structures on soft and weak soil in deeper, more competent soil or bedrock.

Overall, ACP provides reliable, strong, deep foundation support for heavy loads with reduced settlement.

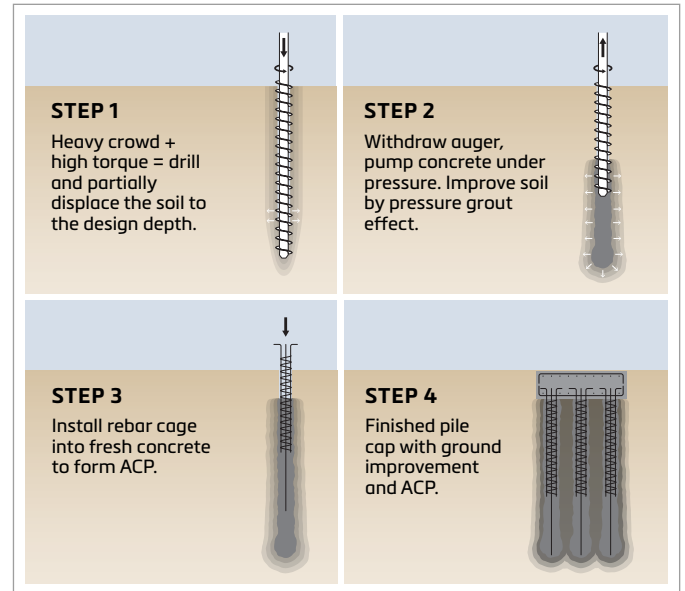

Installation

Auger Cast Pile (ACP) uses partial displacement, continuous flight augers in dense soil regions.

Full-scale, instrumented load tests to 200% confirm vertical bearing and uplift capacity. Lateral load tests can be performed to confirm lateral capacity.

Menard uses heavy, fixed-mast piling drill rigs to install ACP. These rigs install ACP to depths of 20 to 100 feet, and use tool diameters of 14, 16, 18, and 24 inches. The rigs are equipped with electronic monitoring to record drill torque, drill depth, drill speed, grout pump pressures, and grout volume for engineer review.

Applications

Auger Cast Pile (ACP) provide high-capacity deep foundation support,

making them an excellent choice for heavy structural loads and high lateral foundation loads. Each pile is reinforced with steel rebar, ensuring superior strength and durability throughout the life of the structure.

The installation process produces no vibration, which is critical for projects near sensitive structures or in densely populated areas where minimizing disturbance is essential. This feature makes ACP ideal for urban environments and sites with strict vibration control requirements.

Additionally, ACP installations are fully compliant with IBC and CBC standards, guaranteeing adherence to building codes and delivering reliable performance for a wide range of foundation applications. These combined advantages make ACP a proven, cost-effective solution for projects requiring strength,

stability, and minimal impact during construction.

Advantages of Auger Cast Piles Include:

- Soft and loose soil sites and bay mud/sensitive soil sites
- DDP at contaminated soil and undocumented debris fill sites
- Structures with high lateral forces
- Groundwater protection regions
- Sensitive sites with vibration concerns near critical structures
- Sites near occupied buildings and in dense urban areas.